



Weigh Pack Electrical

C500 SERIES



The C500 Series is WPE's latest industrial process controller, equipped with modern interfaces, increased accuracy and user programmability. The C500 Series is the culmination of 25 years of weighing design experience.

Models

- C520, panel mounted with a 14 segment LED display and 6 keys
- C530, no display, optimised for DIN rail mounting for use with HMI



Features

- Compact ½ DIN standard housing
- 10,000d @ 0.5 µ V/d OIML R76
- European WELMEC Compliant legal for trade data storage
- Embedded Linux operating system
- Lua programmability
- Modbus ASCII, RTU, TCP/IP
- Global technical support using Ethernet or RinLink cable

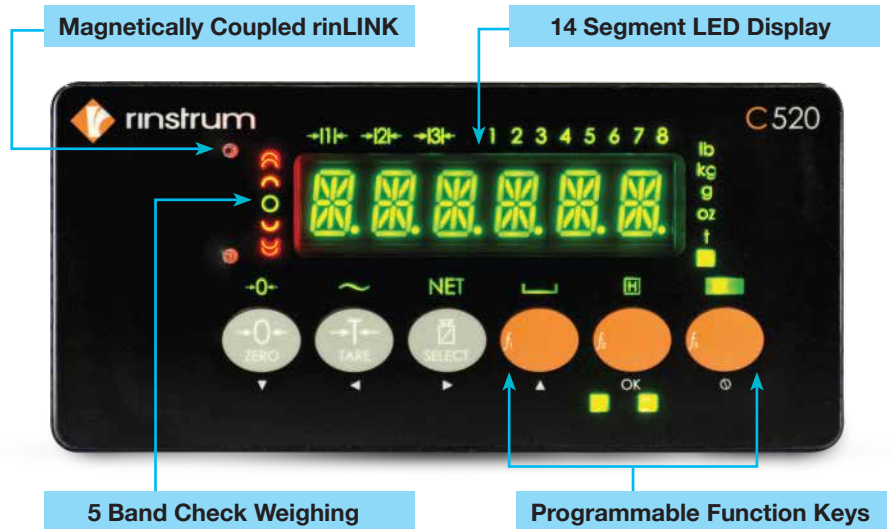



C500 Packages

View Syslog

rinLIB-C500 version 2.2.0

Search...

Modules

- rinApp
- rinLibrary.Device.Analog
- rinLibrary.Device.Buzz
- rinLibrary.Device.Command
- rinLibrary.Device.Dialog
- rinLibrary.Device.FSM
- rinLibrary.Device.Keys
- rinLibrary.Device.LCD
- rinLibrary.Device.Passcod

List of installed packages

Software	Version	Operation
C500-K501	1.0.3	Uninstall
L000-502-M07	1.0.9	Uninstall

rinLIB-C500: API for programming the C500 in Lua

Copyright © 2013-2016 Rinstrument.
This reference is correct for library version 2.2.0 only.
If you do not know where to begin, please start with the [introduction](#).

Modules

rinApp	Module manager for L401
rinLibrary.Device.Analog	Analogue Functions.
rinLibrary.Device.Buzz	Buzzer Handling.
rinLibrary.Device.Command	Library for High level command support.
rinLibrary.Device.Dialog	Dialog Control.
rinLibrary.Device.FSM	Finite State Machine Infrastructure.
rinLibrary.Device.Keys	Key Handling.

Lua Programmability



- Built in embedded Lua scripting
- Enhance the functionality by installing a range of application packages
- Open source library and comprehensive API enable you to write your own applications or engage WPE to write them for you through our fixed price Lua MAX programme
- Use the embedded web server to create browser based user interfaces

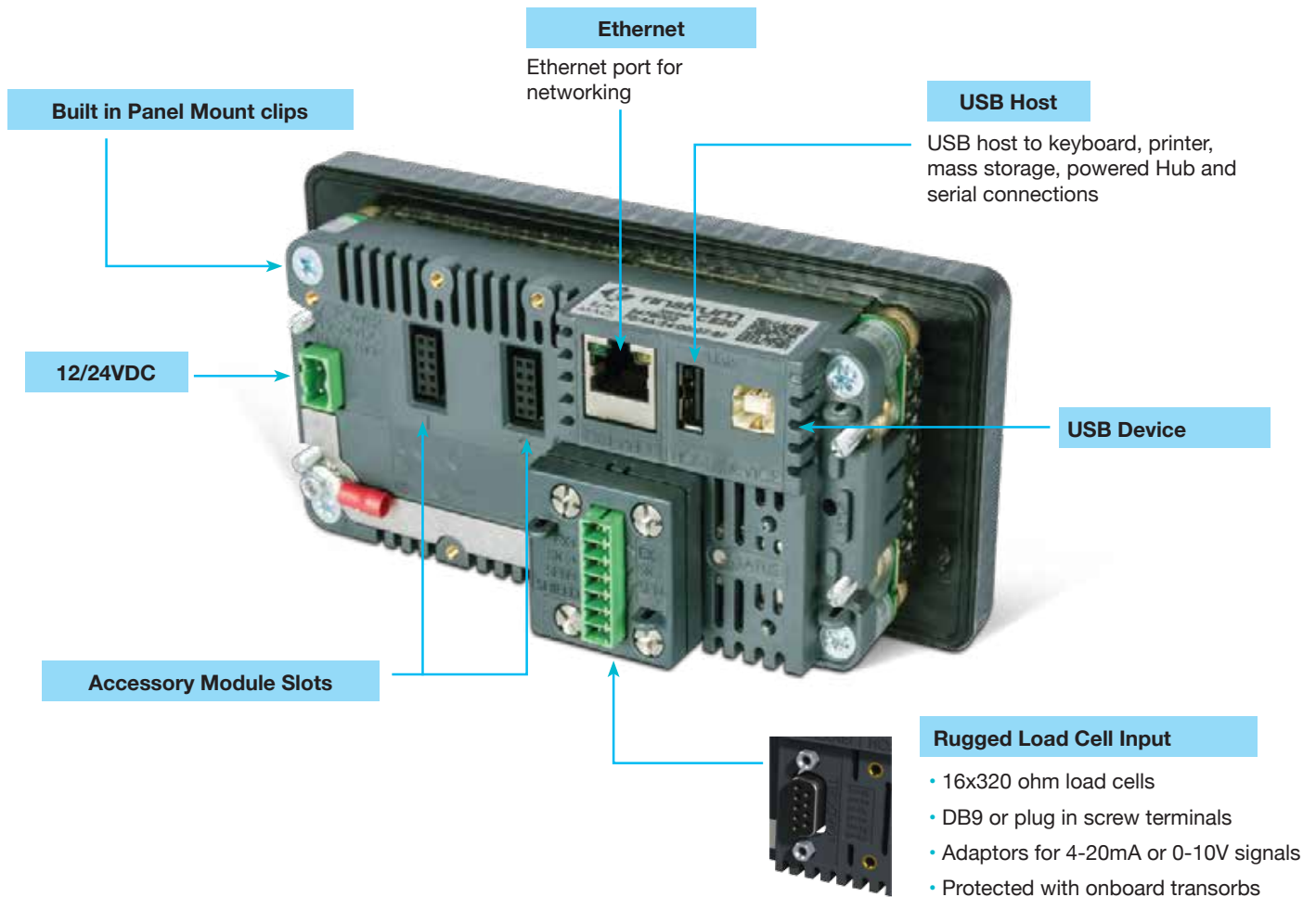

RS232 / RS232 Module	RS485 / RS485 Module	AC Module	Analog Output	I/O Module
<ul style="list-style-type: none"> Electrically isolated RS232 serial communication Status LEDs 	<ul style="list-style-type: none"> Electrically isolated RS485 networking Status LEDs 	<ul style="list-style-type: none"> 110-240 VAC in 12 VDC out 	<ul style="list-style-type: none"> 4-20mA or 0-10V analog output Electrically isolated Fast 400Hz update 2 I/O 	<ul style="list-style-type: none"> 8 I/O Configure as input or output Electrically isolated Status LEDs Outputs - high current DC Active high I/O

C520

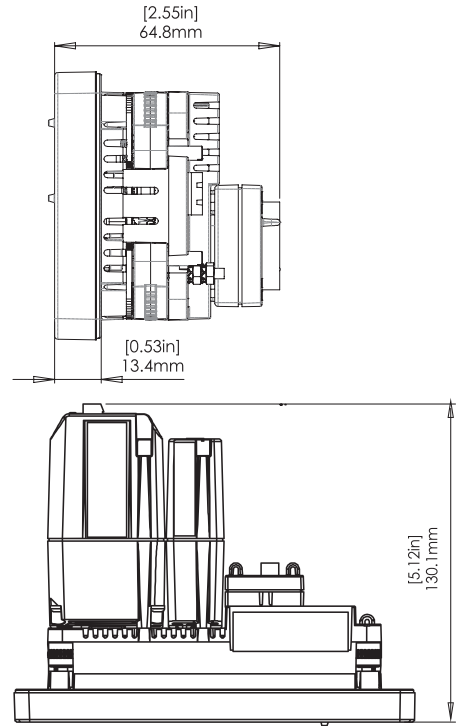
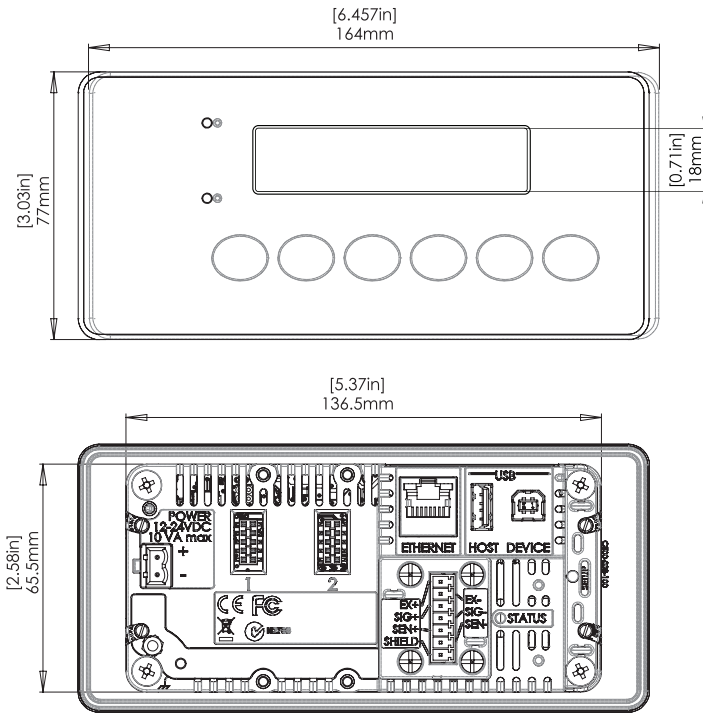

C530

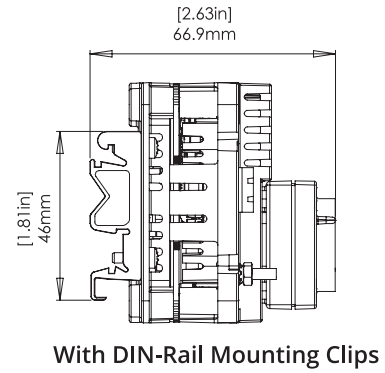
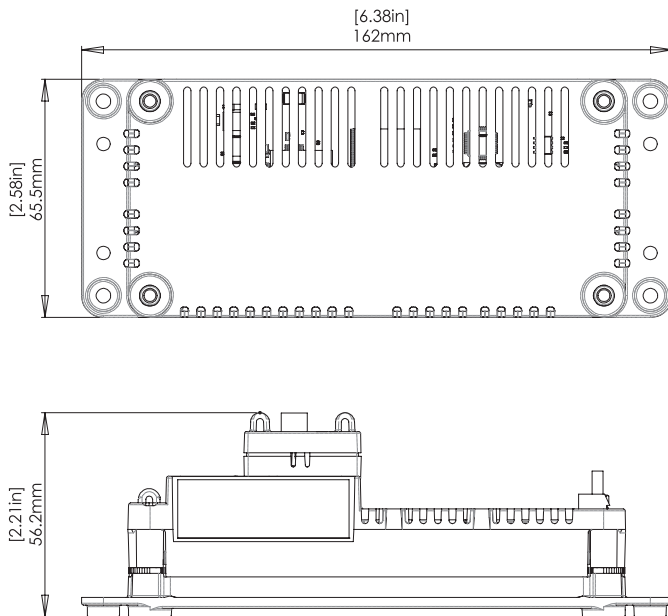

Email: Sales@weighpackelectrical.com.au
Service@weighpackelectrical.com.au

Phone: 0488 199 318